

off the main block, rather in 'domino' fashion. At Donington-le-Heath (c. 1280) (Fig. 31) the hall, on the first floor, has the end east and west walls extended northwards, to contain wings forming a half H-plan. Below there are stone divisions, but above the wings are separated from the hall by timber-framed partitions, in each of which a pointed arch remains. The great chamber was apparently in the north-east wing, and its three windows survive. The other wing, nearer the entrance, has off its north-east angle a further

## DONINGTON - LE - HEATH - MANOR HOUSE FARM

LEICESTERSHIRE

c.1280

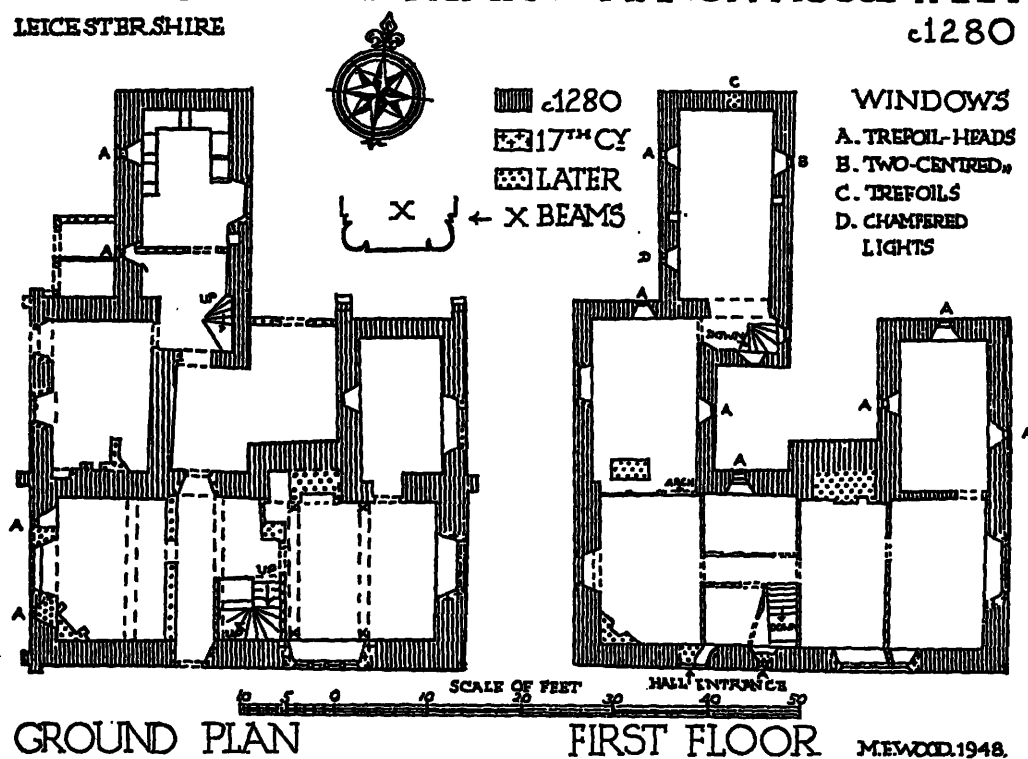

Fig. 31.

block continuing northwards, and partly projecting into a small court, now completed by a brick wall joining the north and solar wings.

A similar half H-plan on a smaller scale is found in the Abbot's House at Netley, an entirely separate domestic building in the Abbey grounds, providing, although in ruins, an excellent example of the 13th-century house plan. The hall is raised on a ribbed vault of three bays, and off its east wall, at either end, there project, again rather in the manner of dominoes, to the north a solar, over a barrel vault, with a garderobe annexe near its north-east angle; and further south a chapel on a ribbed vault of two bays. Cottisford Manor (Oxfordshire) has a plan resembling these.

At Aston Eyre in Shropshire there are remains of a manor house probably of the 14th century. The upper cross-wing projects beyond the hall on both sides and shared an oriel